

CLEANING & SEALING SOLUTIONS FOR TILE & STONE SURFACES



September 2022

INTERIOR & EXTERIOR

Vitrified quarry tiles and full bodied porcelain tiles are extremely hard wearing and easy to maintain. It is possible to make them more stain resistant and if required enhance their appearance and make them easier to maintain. This is a guide to help ensure that treated surfaces remain protected and easy to maintain for many years.

Page 1 of 2

APPLICATION GUIDE - FULL BODIED UNGLAZED PORCELAIN & COMMERCIAL QUARRY TILES - APPLICATION BY HAND HIGHLY VITRIFIED CLAY TILES

STONE & TILE INTENSIVE CLEANER

INITIAL CLEANING OF NEWLY INSTALLED SURFACES

ECOPROTEC STONE & TILE INTENSIVE CLEANER – Cleans & conditions surfaces before sealing

1

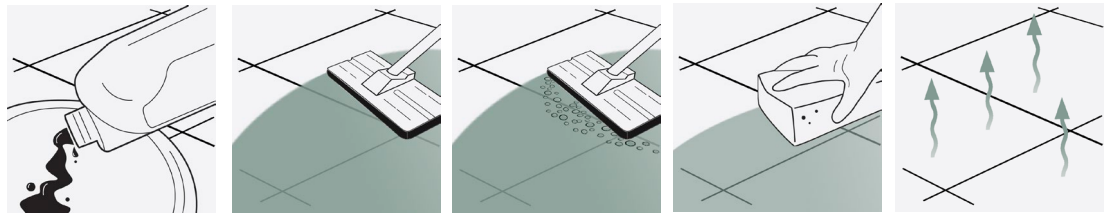

STEP 1.
Dilute solution 1:10 with warm water and apply to surface.

STEP 2.
Working in manageable areas at a time spread out the solution. Leave for 5-10 minutes.

STEP 3.
Add a little water and then scrub surfaces and grout joints to release sediment dirt and grime. Use black pad and pad holder.

STEP 4.
Sponge up released residues. Rinse with water a second time and sponge again.

STEP 5.
Allow surfaces to dry before allowing traffic or sealing.

NATURAL FINISH STONE SEALER

PROTECT AGAINST STAINS - (apply before and after grouting)

ECOPROTEC NATURAL FINISH STONE SEALER - protects against water, oil and grime

2

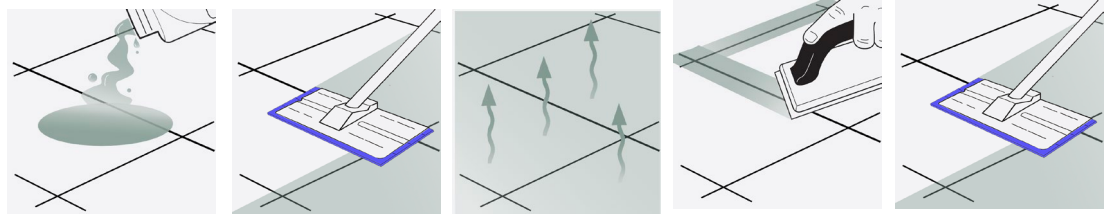

STEP 1.
Before grouting, apply a small amount of sealing solution to the surface.

STEP 2.
Spread out evenly using a sealant applicator pad and pad holder.

STEP 3.
Allow sealer to absorb and dry. Wipe away any excess and leave to dry.

STEP 4.
Leave sealer to cure overnight before grouting the joints. Clean off grout residues and leave to dry.

STEP 5.
Once fully dry apply a final coat of sealer covering the joints. Leave to dry. Buff off any residues with a microfibre cloth to finish.

NATURAL STONE & PORCELAIN AFTER CARE CLEANER

REGULAR AFTERCARE

ECOPROTEC NATURAL STONE & PORCELAIN AFTER CARE CLEANER – Ph Neutral

3

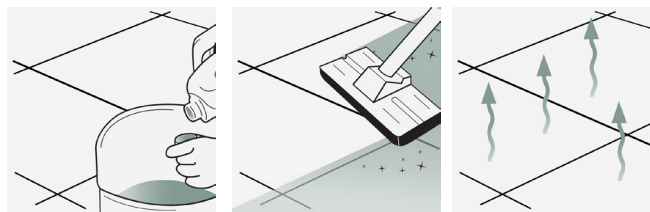

STEP 1.
Dilute 1 capful of cleaner per litre of warm water.

STEP 2.
Mop surfaces with the Solution. Do not rinse.

STEP 3.
Allow to dry. Do not walk on surface during drying time. (20 minutes).

Approx 40 washes from 1 litre of cleaner.

This information is offered without guarantee. The material should be used so as to take account of the local conditions and the surfaces to be treated. In case of doubt, the product should be tried out in an inconspicuous area

CLEANING & SEALING SOLUTIONS FOR TILE & STONE SURFACES



September 2022

INTERIOR & EXTERIOR

EQUIPMENT REQUIRED:

Page 2 of 2

LTP Tools - 4pc pole, pad holder, sealant applicator, white emulsifying pad, deck brush, claw brush, buffing cloths, buckets, sponges, mops.

Ensure that any sensitive surfaces not to be cleaned are properly covered and protected before beginning. Ensure that gloves, eye protection and suitable water proof clothing are worn at all times.

1 CLEANING AND REFURBISHING – used and heavily soiled surfaces

- Before sealing surfaces should be thoroughly cleaned. Old layers of sealer, residues from aftercare cleaners and deposits must be removed from the surface and the pores of the stone. Stubborn film forming layers of sealer can be removed with **ECOPROTEC Stone & Tile Intensive Cleaner**.
- To help remove years of ground in dirt and grime dilute **Stone & Tile Intensive Cleaner** 1:5 with water and apply to the surface. This should be left for 5-10 minutes.
- Agitate the surface using a black pad, scrubbing brush or rotary scrubbing machine and leave for a further 5 minutes.
- Continue to scrub while adding clean water. Remove released residues using a sponge and water or extract using a wet vac.
- Rinse thoroughly with clean water to remove any remaining residues.
- Surfaces should be thoroughly dry before sealing.
- For the removal of other types of dirt see the table below.

OTHER TYPES OF DIRT

Care product residues, oil grease and dirt

ECOPROTEC Stone & Tile Intensive Cleaner

Grout & Cement residues

ECOPROTEC Cement & Grout Residues

2 PROTECTIVE SEAL TREATMENTS

- **ECOPROTEC Natural Finish Stone sealer** will render the surface water and oil repellent.
- This product will help prevent staining, aid cleaning and simplify the removal of stains. Used as a pre sealer it assists with grout release.
- **ECOPROTEC Natural Finish Stone Sealer** will dry and leave surfaces with a natural finish.
- There are no health concerns once the product has properly cured.
- The seal is breathable so can be used on surfaces that are still slightly damp or have no damp proof course.
- Cleaned appropriately using **ECOPROTEC Natural Stone and Porcelain After Care Cleaner** we would suggest topping up the protective treatment every 3 – 4 years.
- Suitable for internal and external use.

NB. Always test products on an inconspicuous area before general application. Surfaces that are non absorbent or saturated with moisture cannot be treated. **ECOPROTEC Natural Finish Stone Sealer** is an impregnating sealer that needs to fully absorb. Any un-absorbed sealer should be buffed off with a micro-fibre cloth or machine with white pad to remove the excess. Some surfaces may be darker after application.

3 AFTERCARE



ECOPROTEC Natural stone and porcelain after care cleaner

High quality every day after care cleaner floor wash that is suitable for interior and exterior use

A gentle cleaner especially formulated to clean natural stone, porcelain and ceramic without damaging the grout, tile or protective treatments, leaving surfaces with a fresh clean fragrance. Suitable for use on both sealed and unsealed, polished and unpolished surfaces. **1 ltr of product will wash a 20 m² surface 40 times.**

NB. Always follow detailed instructions on the product labels. Protect acid sensitive surfaces from contact with acidic substances.. Avoid using steam cleaners, normal detergents or strong bleach cleaners on sealed surfaces as they will gradually remove the protective seal.

This information is offered without guarantee. The material should be used so as to take account of the local conditions and the surfaces to be treated. In case of doubt, the product should be tried out in an inconspicuous area